

# SACC-DSIV-FSD-4CON-L180 SCOTHR

Order No.: 1542648



<http://eshop.phoenixcontact.de/phoenix/treeViewClick.do?UID=1542648>

Bus system flush-type socket, ETHERNET, 4-pos., M12 SPEEDCON, D-coded, rear/screw mounting with M12 thread, with polarity protection, with straight THR solder connection



Ethernet



## Commercial data

GTIN (EAN)	4  046356 097918
sales group	D125
Pack	60 pcs.
Customs tariff	85366990
Catalog page information	Page 294 (PC-2011)

## Product notes

WEEE/RoHS-compliant since: 05/01/2006



<http://www.download.phoenixcontact.com>  
Please note that the data given here has been taken from the online catalog. For comprehensive information and data, please refer to the user documentation. The General Terms and Conditions of Use apply to Internet downloads.

## Technical data

### General data

Note	This product corresponds to the PROFINET Cabling and Interconnection Technology Guideline for PROFINET regulations, version 2.00, order no: 2.252, Chapter 8.2 Connectors for Outside Environment (Balanced cabling)
Rated current at 40°C	4 A

Rated voltage	250 V
Number of positions	4
Volume resistance	$\leq 3 \text{ m}\Omega$
Insulation resistance	$\geq 100 \text{ M}\Omega$
Ambient temperature (operation)	-25 °C ... 85 °C (Male connector / female connector)

### General characteristics

Coding	D - data
Surge voltage category	II
Pollution degree	3
Degree of protection	IP67
Contact material	CuZn
Contact surface material	Ni/Au
Contact carrier material	PA 66
Material of grip body	Zinc die-cast, nickel-plated
Material, knurls	Zinc die-cast, nickel-plated
Sealing material	FKM / EPDM
Mounting type	Rear mounting M12 x 1 With flat nut
Connection method	THR solder connection
Status display	No

### Diagrams/Drawings

Drilling plan/solder pad geometry

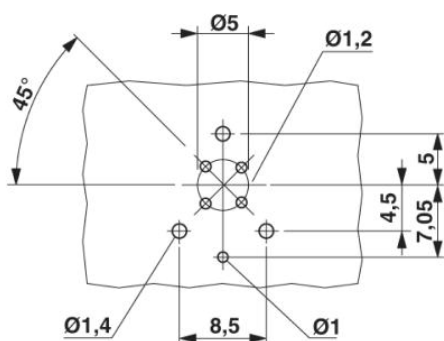

Dimensioned drawing

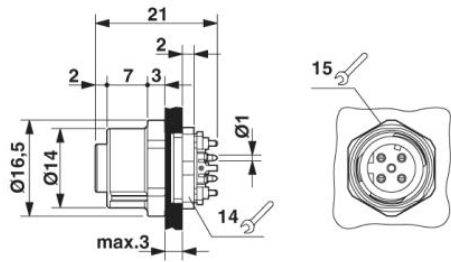

M12 flush-type connector

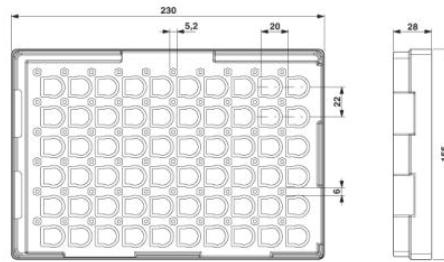

THR tray packaging

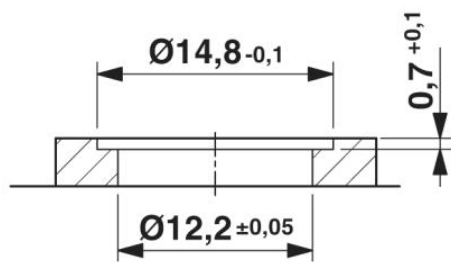

Housing cut-out for two-part M12 flush-type connectors with THR and wave soldering connection, version 1

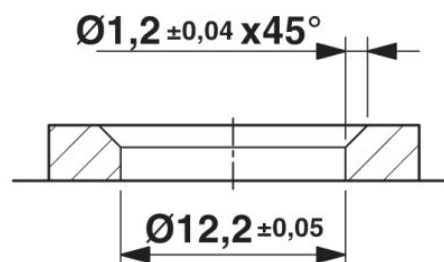

Housing cut-out for two-part M12 flush-type connectors with THR and wave soldering connection, version 2

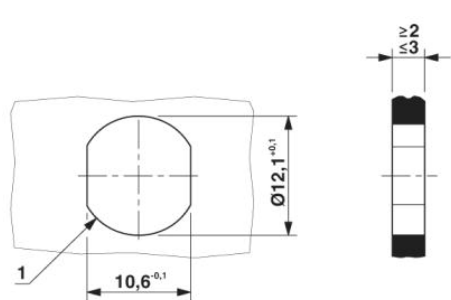

Housing cutout for M12 fastening thread, mounting panel with feed-through hole (alternative with surface as protection against rotation)

Schematic diagram

---

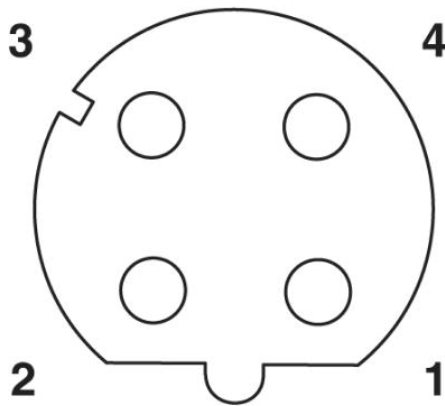

Pin assignment M12 female connector, 4-pos., D-coded, female side

**Address**

PHOENIX CONTACT Inc., USA  
586 Fulling Mill Road  
Middletown, PA 17057, USA  
Phone (800) 888-7388  
Fax (717) 944-1625  
<http://www.phoenixcon.com>



© 2011 Phoenix Contact  
Technical modifications reserved;